

# ROD BORGERT ESTATE AUCTION

# ROD BORGERT ESTATE AUCTION

*3 Rings! 10 Wagons!*

62831 Borgert Road  
Sturgis, MI 49091

*Saturday, September 7 • 8:30am*

Corporate Headquarters:  
950 N Liberty Dr, PO Box 508  
Columbia City, IN 46725



**AUCTION MANAGER:** Robert Mishler • 260.336.9750  
Schrader Real Estate and Auction Company, Inc.  
800.451.2709

Get Our iOS App: Follow Us On:  
 YouTube

**TERMS:** 10% Buyers Premium Capped at \$500. Cash or Check, 3% on Credit Card. Announcements made the day of the auction take precedence over any printed material, & oral statements made. Lunch Available by Amish School. Not Responsible for Accidents.



**800.451.2709 • www.SchraderAuction.com**

*3 Rings! 10 Wagons!*

62831 Borgert Road  
Sturgis, MI 49091

- Tractors
- Forklifts
- Telehandlers
- Farm Equipment
- Trucks
- Trailers
- Shop & Industrial Equipment
- Parts
- Lumber
- Steel
- Irrigation Parts
- Tires
- ATVs
- Lawn Mowers
- Deck Boat
- Farm Misc.
- Shop Tools
- Antiques & More!



# ROD BORGERT ESTATE AUCTION

*3 Rings! 10 Wagons!*

62831 Borgert Road  
Sturgis, MI 49091

- Tractors
- Forklifts
- Telehandlers
- Farm Equipment
- Trucks
- Trailers
- Shop & Industrial Equipment
- Parts
- Lumber
- Steel
- Irrigation Parts
- Tires
- ATVs
- Lawn Mowers
- Deck Boat
- Farm Misc.
- Shop Tools
- Antiques & More!



*Saturday, September 7 • 8:30am*



**800.451.2709**  
**www.SchraderAuction.com**



**800.451.2709**  
**www.SchraderAuction.com**



*Saturday, September 7 • 8:30am*

# ROD BORBERT ESTATE AUCTION

## 3 Rings! 10 Wagons!

### TRACTORS • FORKLIFTS • TELEHANDLERS

- 1991 Military telehandler, Cummins 17.5-25 enclosed cab, 3300 hrs.
- John Deere 2950 open station 18.4-38, 2 remotes, 540/1000 pto, QH, 6898 hours, John Deere 148 loader
- Terex 760 backhoe 4x4 enclosed cab 90" bucket, 24" bucket, Extendahoe, 3053 hours, John Deere controls
- John Deere 620 NF front weights
- Oliver 880 NF older restoration Oliver 88 NF
- Morton tow motor LP gas AC LP gas forklift air tires
- TCM LP gas forklift, side shift, solid tires
- Datsun PF02 LP gas, air tires
- Yale LP forklift Forklift masts
- Backhoe buckets 24"-36"
- Multiple sets of forks, 40" to 72"
- Rafter boom for forks

### FARM EQUIPMENT

- John Deere 2500 7 bottom on-land plow
- John Deere 2500 6 bottom on-land auto reset plow
- John Deere hay rake rubber tooth
- John Deere 4 bottom 3 pt plow
- Brillion 25' spring drag
- 8 Brillion crowfoot plow packers, 8' - 15'
- John Deere 740 20' spring drag
- 13 spring shank disc N injectors
- Multiple wagon gears, some w/ beds
- John Deere 24T baler pto drive, nice, was stored inside
- John Deere 2800 8 bottom on-land auto reset adjustable plow
- (3) John Deere 2500 8 bottom on-land plows
- John Deere 7000 4 row male planter on 12 row front fold bar
- IH 800 10 bottom plow
- John Deere 1360 discbine 9'
- John Deere running gear
- Patriot Down Corn Reel, new, never used, 8 row
- White 435 12 shank disc chisel
- Brillion 20' spring drag Sprayer frame w/ 50' booms
  - New Holland 56 hay rake

### TRUCKS • TRAILERS

- 1989 IH 2554 dump truck, 376,019 mi., auto transmission
- 1996 Volvo VED12 engine, aluminum rims, wet kit
- 1998 2674 dump truck belly blade 277,044 mi. LL 8 speed transmission
- 1996 IH 1900 dump truck 5 & 2 transmission
- IH S-2600 w/ ITec manlift boom
- Chevy 3500 HP 5 spd, 146,846 mi.
- GMC 6500 dump truck V8 5+2 trans
- Ford F550 6.0 diesel w/ Versalift
- Trail Cruiser spread axle implement trailer
- 1996 Trailmobile 100" wide x 47' van trailer
- Single axle semi dolly
- 1980 Great Dane 92"x45' van trailer
- 1996 Trailmobile 98"x53' van trailer
- 2000 92"x48' reefer trailer
- Fruehauf s.s. 92"x40' vintage van trailer
- LaCrosse 23' flatbed semitrailer w/ ramps
- GN 20' triaxle steel trailer
- Boat trailers
- GN 24' 3 axle flatbed trailer
- Boss V plow 7'6"
- (4) new 8 lug torsion axles
- Car dolly
- Steel & aluminum dock plates
- Trailer safety dock jack
- Buff 8' fiberglass cap

### SHOP & INDUSTRIAL EQUIPMENT

- Saxmayer Bundle-Matre
- Doall metal 24" bandsaw
- Toledo scale
- Tannewitz wood 18" bandsaw
- Cast iron vintage bandsaw
- Large drill press & arbor bits
- Edge sander for metal w/ blower
- Lathe 8' bed
- Northfield Foundry & machine bandsaw
- Idea iron worker
- Face grinder
- Famco 612 metal bandsaw
- Rockwell 6" jointer
- Sprunger table saw
- Atlas scroll saw
- Vintage shop crane
- Fosdick drill press
- Electric hydra pump
- Miller roughneck IE gas powered stick welder

- Powermatic 12" bandsaw
- Lodge & Shipley 3 jaw metal lathe
- Linde mig welder
- Hydraulic shop press
- Lincoln Idealarc arc welder
- Bandsaws
- Shop grinders
- Metal & plastic banders & tools
- Tops power saw
- Grob Brothers bandsaw
- Green Lee bandsaw
- 74" metal brake
- (2) Wellsaw 1000 metal bandsaws
- Heavy duty steel work tables
- Metal & wood storage cabinets & cupboards
- Overhead crane hoist
- Metal lathe 4 jaw chuck 60"
- 8' metal brake
- (3) Shop Smiths
- Yates American lathe
- (2) spindle drill presses
- DeWalt radial arm saw
- Heavy duty 12" shop grinder
- Johnson 20"
- Doall 24" wood bandsaw
- Delta Rockwell radial arm saw, hydra drive Con-estega 18" wood bandsaw
- Atlas metal lathe 24" electric
- Several large air compressors
- Large spindle sander
- Sprunger table saw
- Jet jointer
- Rockwell 12" table saw
- C.O. Porter 10" jointer w/ power feed
- Parks wood bandsaw
- Leten bandsaw
- Roll around A frame overhead hoist
- Rockwell shaper
- Samson 16" metal chop off saw
- (2) large commercial size sand blasters
- (2) Barnes industrial drill presses
- Rockwell table saw
- Atlas scroll saw
- Several pallet jacks

**AUCTIONEER'S NOTE:** Due to the passing of Rod Borgert, we will sell Farm Equipment, Trailers & lots of Parts & Misc. Everyone that knew Rod knew he was an avid auction buyer. There will be something here for everybody.



### ATVS • LAWN MOWERS • DECK BOAT

- Several overhead crane trolley rollers, various sizes
- Lincoln ProCut 55 plasma cutter
- (3) Johnson model J 20" metal bandsaws
- Powermatic scroll saw
- Ritter clamp table
- Several torch carts
- Quincy Horizontal air compressor w/ Honda GX390 belt drive engine, cast iron pump
- Woodmaster hydraulic drive 18" wood planers
- Several drill presses
- 2 Hotsy hot water washers
- Super Blast electric hot water washer

### PARTS • LUMBER • STEEL

- John Deere 47 kg suitcase weight
- John Deere sway backs, weight brackets, 3rd links, weights
- Oliver clam shell fenders
- 9 bolt dual hubs
- Lots of hydra cylinders
- Nitrogen knives, new Plow points & coverboards
- New 4" ratchet straps
- New disc blades
- IH 3800 fiberglass bus hood
- Crate of plow coulters
- Military truck bed
- IH K & M step
- J bolts for duals New turn buckles
- An abundance of dimensional lumber & plywood
- Bundle of 2x4x8 1/2 dimensional lumber
- RV parts
- Pallet of Reece type hitches
- Racks of structural steel
- Angle, channel & tube steel unused up to 25' long

### IRRIGATION PARTS • TIRES

- 3 Vermeer winch irrigators w/ Wisconsin gas engine
- Rainbow traveler
- Rolls of irrigation winch cable
- Irrigation riser pipes
- New irrigation tires 14.9-24
- New Valley gear boxes

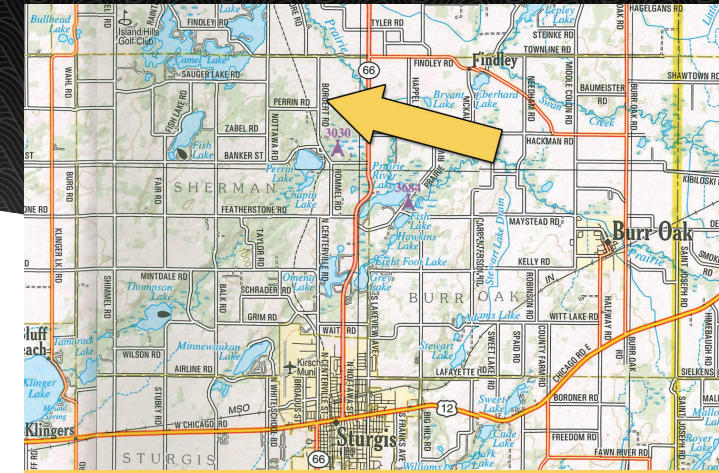

**LOCATION:** 62831 Borgert Rd, Sturgis, MI 49091 • Located 4 mi. north of Sturgis, Michigan on Centerville Rd to Featherstone Rd go east a 1/4 mi. to Rommel Rd (which becomes Borgert Rd at next stop sign) north 3 mi. to auction.

- Polaris XP 900 HO Ranger w/ Polaris hard side cab 217 hrs & 1,067 mi.
- Yamaha Star Classic motorcycle, windshield & saddle bags
- Hustler hydro 272 lawn mower
- (2) John Deere 110 garden tractor blade & deck
- Parker leaf vacuum
- Yamaha Big Bear 350 4x4 ATV
- Hustler 295 gas lawn mower
- Kawasaki 3010 Mule Crew 4x4
- John Deere 214 garden tractor w/ deck
- Woods Mow'n Machine 5200, gas, w/ bagger
- Gilson RT5S rear tine tiller
- Antique walk behind garden tractor on steel wheels
- Hustler 285 front mtd. lawn mower
- Viking Sport Deck deck boat

### FARM MISC • SHOP TOOLS

- 150 gallon fuel tank w/ 12V pump
- 1000 gallon fuel tank w/ pump & meter 1000 galon poly tank
- Fill Rite 12V fuel pump, new Multiple heavy duty steel racking
- Grain screw in Aerators
- Arkfeld livestock scale
- 3 pt forks
- Snyder 300 gal. saddle tanks
- Pallet of baler twine
- Corn crib, dismantled
- Fork mast
- Oil barrel pump
- LP tank on gear w/ hose
- Log chains
- New bundle or roll of 1" hemp rope
- New Westinghouse 8000 generator
- 1" air impacts
- Pallet of C clamps
- 3 rotating bolt bins Parts washer
- Heavy duty jack stands
- Heavy duty extension cords
- Wood stepladders, 12' & 15'
- Bar clamps
- Wiring spool rack w/ 10 spools
- Milk cans
- Log tongs
- Mosler standup safe
- Heavy duty casters of all sizes
- Square D electric box 7'x9' w/ conduit parts
- Rigid pipe vice
- Aluminum RR jacks
- Pallet jacks
- Fire engine hose
- Multiple live traps
- Aluminum truck tool boxes
- 3 section hydra valve body
- Transfer pumps
- Sledge & axe handles
- Large bolt caddy
- 2 sided cantilever rack
- Skids of roof slate
- Very large assortment of tires, implement, semi, tractor & auto
- Wagon load of hardware
- Antiques from a 4th generation farm house not yet sorted

### ADDED BY JIM BORBERT

**INSPECTION DATE:** Fri, Sept. 6 • 10am-2pm

# Saturday, September 7 • 8:30am