

**SCHRADER**  
Real Estate and Auction Company, Inc.

CORPORATE OFFICE:  
950 N. Liberty Dr., Columbia City, IN 46725  
email: auctions@schraderauction.com

# BORGERT EQUIPMENT AUCTION

Sturgis, MI • ST JOE COUNTY **2 RINGS**

**AUCTION MANAGER:**  
Robert Mishler,  
260-336-9750

AC63001504, AU08701553

| NOVEMBER 2023 |     |     |     |     |     |     |
|---------------|-----|-----|-----|-----|-----|-----|
| SUN           | MON | TUE | WED | THU | FRI | SAT |
|               |     |     | 1   | 2   | 3   | 4   |
| 5             | 6   | 7   | 8   | 9   | 10  | 11  |
| 12            | 13  | 14  | 15  | 16  | 17  | 18  |
| 19            | 20  | 21  | 22  | 23  | 24  | 25  |
| 26            | 27  | 28  | 29  | 30  |     |     |

**TERMS:** Cash or Check w/proper ID.  
3% surcharge fee for credit cards.  
Announcements made the day of the auction take precedence over any printed material. Not responsible for accidents.

Follow us on: YouTube

Get our iOS App

**800-451-2709**  
**SchraderAuction.com**

# BORGERT EQUIPMENT AUCTION

**2 RINGS**



- TRACTORS • JD COMBINE
- HEADS • GRAIN CARTS
- SEMIS • TRUCKS • TRAILERS
- WHEEL LOADERS • BACKHOE • DOZER
- TELEHANDLERS • SKID STEER
- IRRIGATION EQUIPMENT
- TILLAGE EQUIPMENT
- FARM EQUIPMENT • JD BALER
- PLANTING & FERTILIZER EQUIPMENT
- GRAIN VAC • WAGONS • AUGERS
- SHOP EQUIPMENT • RANGER • UTVs • ATVs

**800-451-2709**  
**SchraderAuction.com**

**LIVE INTERNET BIDDING**  
Visit [SchraderAuction.com](http://SchraderAuction.com) for Details  
or call 800-451-2709.

**SCHRADER**  
THE ORIGINAL MULTI-TRACT AUCTIONS

**FRIDAY, NOVEMBER 24 • 10am**

# BORGERT EQUIPMENT AUCTION

Sturgis, MI ST JOE COUNTY

**2 RINGS**



- TRACTORS
- JD COMBINE • HEADS • GRAIN CARTS
- SEMIS • TRUCKS • TRAILERS
- WHEEL LOADERS • BACKHOE • DOZER
- TELEHANDLERS • SKID STEER
- IRRIGATION EQUIPMENT • TILLAGE EQUIPMENT
- FARM EQUIPMENT • JD BALER
- PLANTING & FERTILIZER EQUIPMENT
- GRAIN VAC • WAGONS • AUGERS
- SHOP EQUIPMENT • RANGER • UTVs • ATVs

**LIVE INTERNET BIDDING**  
Visit [SchraderAuction.com](http://SchraderAuction.com) for Details  
or call 800-451-2709.

**SCHRADER**  
THE ORIGINAL MULTI-TRACT AUCTIONS

**800-451-2709**  
**SchraderAuction.com**

**FRIDAY, NOVEMBER 24 • 10am**

Auction held at: 62831 Borgert Rd., Sturgis, MI 49091

# BORGERT EQUIPMENT AUCTION

Sturgis, MI • ST JOE COUNTY

FRIDAY, NOVEMBER 24 • 10am



## TRACTORS

• **JD 9300** quad trans, bare back, 4 remotes, 710/70R38 tires, inside wheel weights, 4,435 hrs, #RW9300H010612 • **JD 8960** 520/85R42, 3 remotes bareback, #1734, 8842 hrs • **JD 8630**, 3pt, PTO, QH, 3 remotes, 30.5-32 single tires good rubber, show 1,608 hrs, #8630H008018R • **JD 4960 MFWD**, 3 remotes, 16.9-30 front & 18.4-46 rear tires, QH, shows 3,900 hrs • **JD 4640**, 3 remotes, QH, 18.4-42 10 bolt duals • **New Holland T6030 MFWD** plus cab, LH reverse, Tiger Saber sidearm mower, hydraulic drive, 18.4-34 tires, 4,983 hrs • **JD 4020 diesel** wide front side console, 2 remotes, diff. lock, 18.4-34 tires, JD quick hitch with JD 158 loader and forks • **(2) JD 2cyl tractors for parts • Farmall M**

## JD COMBINE • HEADS • GRAIN CARTS

• **JD 9650 combine** 520/85-38 Straddle Duals chopper, 1,239 Eng/727 Sep hrs • **JD 930F full finger flex head**, #H00930F701318 • **JD 843 poly corn head** • **JD 643 corn head** • **Horst head cart** • **UM UT25 head cart** • **(2) Demco 850 grain carts**, 30.5-32 tires, tarp, low use • **Male row destroyer**

## SEMIS • TRUCKS • TRAILERS

• **1986 IH S1900**, 5 spd, IH 6 diesel, Heil 8' dump bed, 83,170 miles • **1996 Volvo day cab**, air ride, wet kit, 295/75 22.5 Tires all aluminum rims, 12.1 L Volvo engine • **1998 IH 2674**, 8 spd LL, belly blade, 12' bed with sand chain web & sander 11R-22.5, 277,044 miles, #5015 • **1996 IH 8100**, 9 spd, Cummins Mll air ride susp. 11R22.5, 446,971 miles, #6870 • **1974 American 37' hopper trailer** 52" sides 24.5 tires • **1990 Ford 800** 5 & 2 trans air brakes 370V8 gas air tag axle, 12' bed, aluminum rims, #7192 • **1999 IH 2674** eng Eaton Fuller 8 spd LL, 13' bed, with sand & salt chain, 87,155 miles • **1976 Ford 8000 dump truck** 10 spd Heil 14' dump bed & hoist Cat 3208 • **IH National crane truck** • **Ford L8000 diesel truck** with aluminum bulk feed bed • **1999 Ford F550** 4x4 crew cab, 305,971 miles, Tuscan Conversion Western Star hauler bed, snowplow hook-up • **1989 Iveco diesel**, 5 spd diesel, 20' flatbed, #4288



**AUCTION LOCATION:**  
62831 Borgert Rd., Sturgis, MI 49091  
Located 4 miles north of Sturgis, MI on M66 to Banker St., then follow Banker St. 2 miles to Auction. (Banker St. becomes Borgert Rd.)

## • 1978

**IH LoadStar 1800** 5x2 trans, shows 18' Schien grain bed & hoist • **GMC 6500** V8 gas, 5 & 2 trans., with dump bed, PerfectLon dump bed & hoist, 10' • **1987 IH G2604** 21' bed tandem axle 22.5 Tires, ITEC snorkel with man basket, approx. 80' • **1976 Ford 8000 dump truck** 10 spd Heil 14' dump bed and hoist Cat 3208 • **1984 IH 1600**, 99,000 miles, 5 & 2 trans, V8 gas, 15' steel grain bed and hoist • **1989 Ford L7000** diesel, 6 spd trans, 37', 196 miles, cab and chassis, pto • **1989 IH 2554** gas auto trans, 376,018 miles, 10' dump bed and hoist • **1986 IH 1954**, shows 27,088 miles, 5 & 2 trans., with 5 compartment fuel body • **1998 Mercury Gran Marquis LS**, leather, 4.6 gas • **1993 Ford F-250** gas ext cab 8' bed • **2005 Ford F-550** 6.0 diesel 4x4 with Versalig 1240 40' man basket with crane • **1997 Chevy 3500**, 4x4, 252,153 miles, power windows 454 gas • **2001 Ford F250** ext cab 7.3 diesel, 8' bed • **2000 Astro van** #9240 130,000 miles, 4.3 V6 • **1986 Cronkwhite implement trailer** #3354 24' with ramps, dual wheels • **American GN equipment trailer** foldout out riggers, hydra tilt, 21' ramps, tandem duals tandem axle dual wheels • **Delphi Works, extendable hitch telephone trailer**, #12046 Tandem axle RV frame • **RGN 30' trailer**, 20' well • **15' pintle trailer** • **1989 Beck bumper trailer** with ramps #4288 • **Blue GN tandem axle** dual wheels, hydra sliding hitch, needs a floor • **Brute D18R triaxle pintle trailer** with ramps • **New Dodge dually pickup bed** • **27' yellow trailer** with spring assist ramps 240/75 17.5 tires • **27' tandem axle bumper trailer** • **1998 Ehrlich 35' GN tandem axle duals**, 20,000# toolboxes, yellow ramps, #1901 • **Single axle Joe Dog dolly** • **1999 Ford F350 crew cab** 4x4 dually, 7.3 diesel, 201 1993 GMC 2500 4x4, 5.7 gas, 147, 970 miles • **2004 Ford F350** ext cab, 8' bed, 257,736 miles

Visit Website for More Photos!!

## WHEEL LOADERS • BACKHOE • DOZER • TELEHANDLERS • SKID STEER

• **Kawasaki KSS8522**, 23.5-25 Tires, 112" bucket, Cummins NTO-6 CT, shows 4938 hrs • **Michigan/Clark 23.5-25 Tires 9' bucket**, 6406 hrs, 85GM-38A • **Komatsu D39P wide track dozer**, 6 way blade, 4600 hrs, #4750002P5772 • **Case 580 Super K** 4x4 extendahoe, 4500 hrs, 24" bucket JRB 9' bucket • **Snow blade** with skid steer attachment • **JCB 508-40 telehandler** • **Military telehandler**, 5265 hrs, Cummins diesel TCR 6000#, 4x4x4 • **Petibone B-66 telehandler** 13-24 tires, 4,526 hrs • **Komatsu SK1026 Turbo 2spd** • **36" backhoe bucket** • **Root/brush bucket** for front end loader JRB forks • **Yale LP Forklift** • **Allis Chalmers Forklift** • **Nissan Forklift**, LP gas • **Caterpillar 303CR mini excavator**

## IRRIGATION EQUIPMENT

• **Aquamat GH hard hose traveler** Komet 202 & gun • **Micro Rain model MR-43** turf irrigator • **Rainbow traveler** • **Aluminum irrigation pipe** and trailer • **Pivot points**

## TILLAGE EQUIPMENT

• **JD 637 Rock Disc 26'5"** (this disc was bought new, parked in the barn and never used) • **Brent CPC 7 shank disc ripper** • **Sunflower 1234 32' rock flex tandem duals**, new blades 24" rear hitch and hydraulics • **Krause 4990 rock flex 28' disc 22" blades** hydra fore aft • **JD 960 field cultivator**, new sweeps, shank protectors, spike drag, 33' walking tandems • **Brent CPC 7 shank disc ripper** • **Brillion 25' crowfoot X-108 X-fold packer** • **Killbros rolling basket**, missing one • **Case IH 28' single basket crumbler**, spring cushion Case IH single basket 36' crumbler • **JD 200 rolling basket**, 32' • **JD 200 rolling basket**, 35' • **JD 200 rolling basket 30' spring** • **JD 714 disc chisel 12 shank** • **Yetter 3530 30' rotary hoe**, good spoons Brillion XL-Series Optimizer 32'

## FARM EQUIPMENT • JD BALER

• **JD 637 round baler** • **JD 435 round baler** • **JD MX8 rotary mower**, 540 pto • **Lofness 20' flail mower** with end transport • **(2) Rock-O-Matic 546 pull type rock pickers**, pto reel • **Hydraulic rock rake** • **HD 3 pt.** 9' 6 way blade • **Lots of disc and planter parts**, JD planter units • **Fuel wagon** with (2) 500 gal. tanks and 110V pumps and meters and generator mtd on Hd gear • **4 Good Year 480/80R46** Leveler bar for chisel plow HLA 108" bucket • **Taylorway TP 270** 10' pull type rotary mower, 540 pto JD 3 pt. silage blade • **JD antique 1 btm plow** • **JD 145 5 btm plow** • **Flatlander 8' lawn roller**

## PLANTING & FERTILIZER EQUIPMENT

• **JD 7200 MaxeMerge2**, 16RN vacuum planter • **JD 1770 MaxEmerge Plus**, 16RN liquid planter • **JD 750 20' drill**, 7 1/2", Yetter markers, dolley wheel, Market Poly fill auger, #NOO750X012371 • **JD planter trailer** • **1974 Miller trailers flatbed** with side kit, has 4- 1000 gal. tanks and cast iron pump • **1000 gal. poly nurse tank** with gas engine & pump • **1000 gal 12 row applicator** 380/80R 38 tires, John Blue pump • **Tote carrier** • **1000 gal. tank frame** • **1600 gal. cone bottom tank** on frame • **1000 gal. s.s. Ed's sprayer**, John Blue pump • **George White 500gal field sprayer**, 45' booms, 20" centers, hydra pump

## GRAIN VAC • WAGONS • AUGERS

• **Konskilde Supra Vac 2000 grain vac** 1000 pto • **Demco 550 gravity wagon** • **(6) Parker 2500 & 2600 gravity wagons** • **J&M 350 gravity wagon** • **Cardinal 10"x60 pto drive auger** • **Hutchinson 10x71 swing away auger** • **Brandt MD 10x71 swing away auger**, 540 pto

## SHOP EQUIPMENT

• **Drive on truck hoist** • **Lincoln mig welder** • **Gardener-Denver air compressor** industrial portable with gas engine, 2,964 hrs • **Walker Turner HD bandsaw** • **Hobart Fabricator**, Hobart 2210 • **Leroi Air Compressor** portable, gas eng, 1,900 hrs • **Johnson metal bandsaw** • **Lincoln Idealrc 250 welder** • **Jet Bridgeport Mill** • **Fire Proof Cabinets** • **Air Jacks** • **Aircro Welder Generator** • **Drill Press** • **WF Wells HD metal bandsaw** • **Bridgeport Milling machine** • **Metal Iron Worker** • **Large Pedestal Grinder** • **Fiberglass raised gardens**

## POLARIS RANGER • UTVS

### • ATVS

• **Polaris XP 900 HO Ranger** with Polaris hard side cab 217 hrs and 1,067 miles Polaris Prospector Pro Tracks • **Kawasaki Mule Trans** • **Yamaha Kodiak 450 4x4** • **Toro UTV** gas eng with hydra dump • **Cushman 6110 51hp** wide area mower • **JD 212 lawn tractor** • **JD F935 diesel 72"** • **Woods Mowin Machine**, 5,200 hrs with bagger

**INSPECTION DATES:**  
Saturday, November 18<sup>th</sup> • 8am - 1pm  
Wednesday, November 22<sup>nd</sup> • 3-6pm



**AUCTIONEER'S NOTE:**  
Due to the passing of Rod Borgert we will be selling his Farm equipment. Everyone that knew Rod, knew he was an avid Auction buyer so there will be something for everyone!  
**Rod Borgert Estate**  
62831 Borgert Rd., Sturgis, MI 49091

**LIVE INTERNET BIDDING**  
Visit [SchraderAuction.com](http://SchraderAuction.com) for Details or call 800-451-2709.

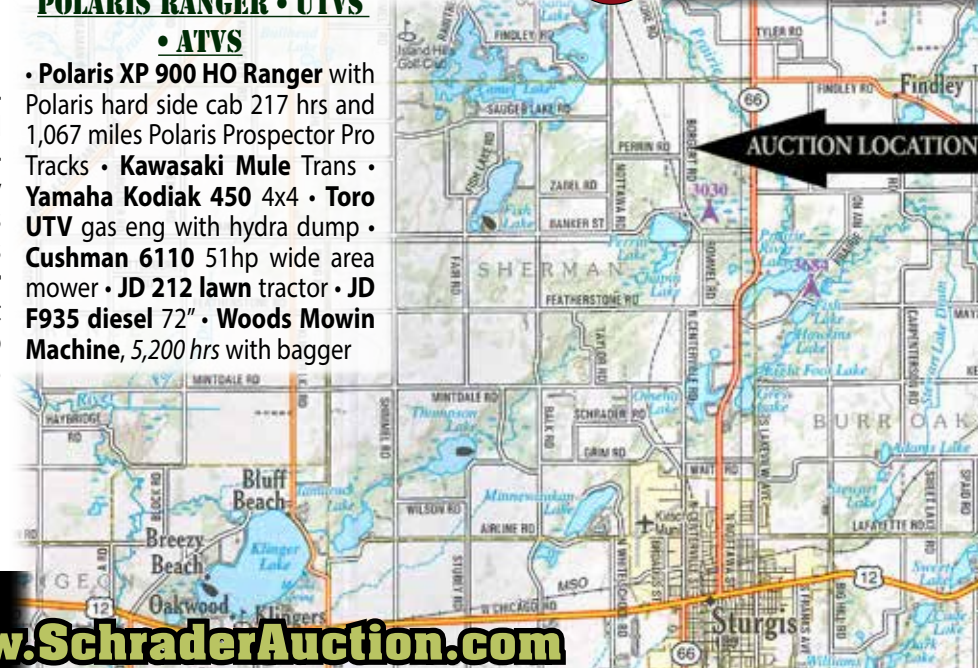

**SCHRADER**  
Real Estate and Auction Company, Inc.

Call 800-451-2709  
or Visit our Website [www.SchraderAuction.com](http://www.SchraderAuction.com)

SELLER: Rod Borgert Estate • AUCTION MANAGER: Robert Mishler, 260-336-9750